



Current Status: Active

PolicyStat ID: 3972690



**Origination:** 10/2011  
**Effective:** 10/2017  
**Last Approved:** 10/2017  
**Last Revised:** 10/2017  
**Next Review:** 10/2020  
**Owner:** Tracy Hasty: Mgr Unit  
**Policy Area:** PACU  
**References:**  
**Applicability:** WA - Kadlec Regional Medical Center

## Pre-Op Patient Flow, 49.02.00

### SPACE ASSIGNMENT:

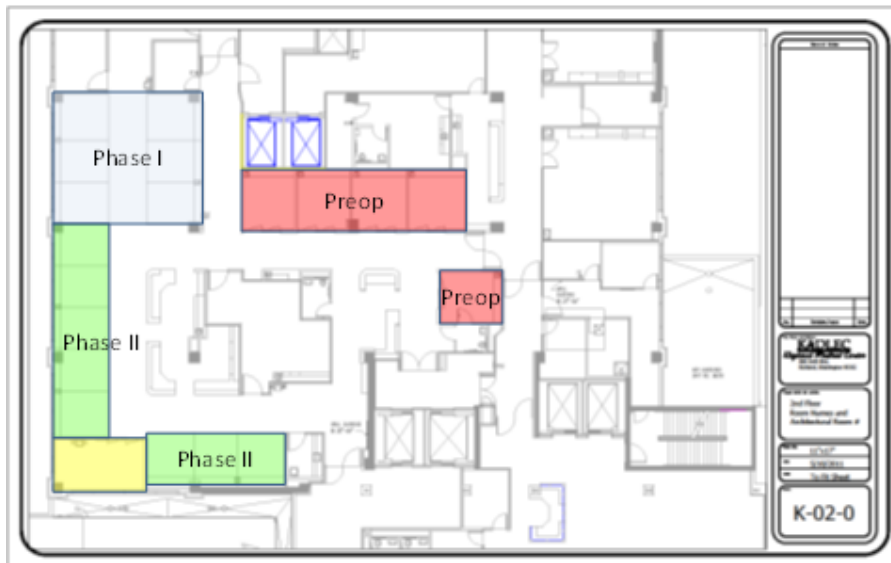

- Pre-Surgery Bays 1 thru 12.
- Phase I Bays 12 thru 20.
- Phase II Bays 6-14.
- Bay 9: Use for Pediatric Recovery Phase I primary and Phase II secondary and patients with special needs.
- Nights and Weekends: Pre-Surgery Bays 1 thru 5, Phase I and II in Bays 8– 20.

### ATTACHMENTS:

- Pre-Op Standard Flow
- Pre-Op Inpatient Flow
- Pre-Op Same Day Unplanned Flow
- Pre-Op Heart Case Flow
- Pre-Op Knee and Hip Flow

## Attachments

- Process Flow Worksheet – Pre-Op – Heart Case Flow
- Process Flow Worksheet – Pre-Op – Inpatient Flow
- Process Flow Worksheet – Pre-Op – Knee & Hip
- Process Flow Worksheet – Pre-Op – Same Day Unplanned Flow
- Process Flow Worksheet – Pre-Op – Standard Flow

## Approval Signatures

Approver	Date
Kirk Harper: VP, Nursing & CNO	10/2017
Crystal Wise: Administrative Assistant	10/2017
Tracy Hasty: Manager, Unit	10/2017

## Applicability

WA - Kadlec Regional Medical Center

COPY